



Apt 150 City Gate II, 3 Blantyre Street, Castlefield, Manchester, M15 4EB

Jordan Fishwick are pleased to offer for sale this large 4th floor one bedroom with occasional 2nd bedroom/study is located a short distance from Deansgate and the motorway network. Entrance hall, large living room with patio doors to balcony, separate kitchen, spacious bedroom again with patio doors onto the balcony. Bedroom/study, (no window), three piece suite with shower attachment. No Chain
Cladding works have been completed and an EWS1 form is due imminently. In the meantime a 'Letter of Comfort' is available from the developer (Bellway) who have funded the works.

Price £175,000

Viewing arrangements

Viewing strictly by appointment through the agent
245 Deansgate, Manchester, M3 4EN 0161 833 9499 opt 3

Entrance Hall

Telephone entry phone, cupboards housing hot water system. Access to all rooms.

Living Room

15'1" x 13'0"

Excellent room with double glazed patio door leading onto the balcony. T.v point and electric heater

Kitchen

10'4" x 9'5"

Modern fully fitted kitchen with a range of matching base and eye level units. Space for fridge/freezer, electric oven, four ring hob and stainless steel extractor hood over. Linoleum flooring.

Bedroom One

23'0" x 10'10"

Excellent room with double glazed patio door leading onto the balcony. T.v point and electric heater

Occasional Bedroom/Study

9'8" x 8'6"

Ideal spare room as has no natural light or window in it.

Bathroom

7'2" x 5'7"

Three piece suite with shower attachment, part tiled walls, heated towel rail.

Balcony

Covered balcony with access from the living room and bedroom.

Additional Information

Ground rent £256.85p per annum Review period TBC

Service charges £2400 per annum Approximately

Lease 150 years from 2000

Building Managing Agent - Zenith

Agents Notes

To be able to purchase a property in the United Kingdom all agents have a legal requirement to conduct Identity checks on all customers involved in the transaction to fulfil their obligations under Anti Money Laundering regulations. We outsource this check to a third party and a charge will apply. Ask the branch for further details.

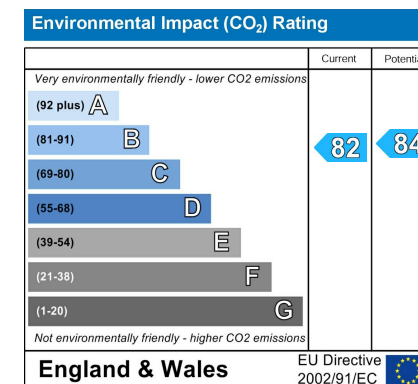
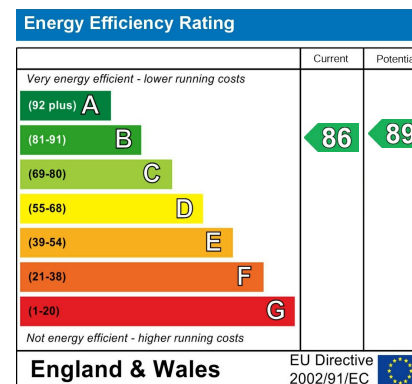



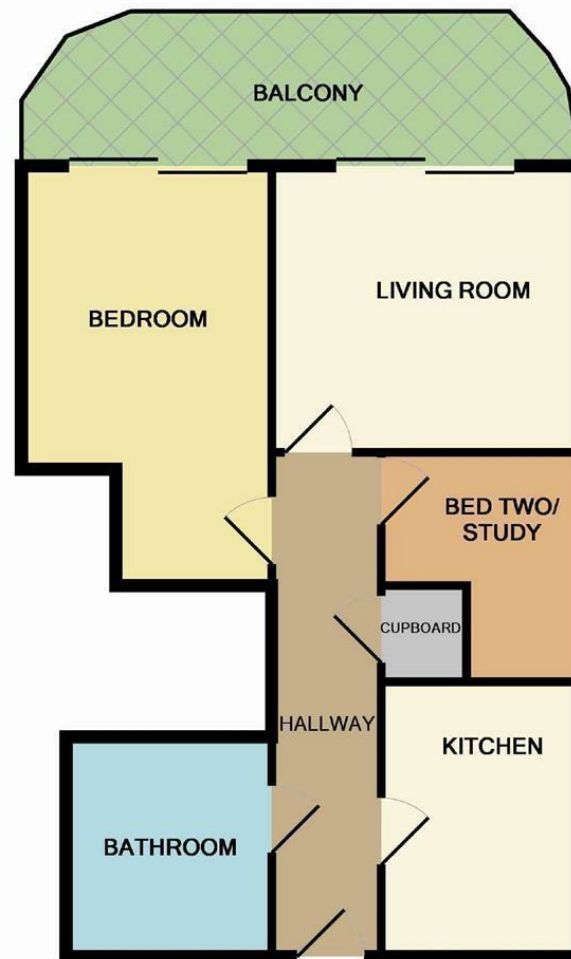

Measurements are approximate. Not to scale. Illustrative purposes only
Made with Metropix ©2013



These particulars are believed to be accurate but they are not guaranteed and do not form a contract. Neither Jordan Fishwick nor the vendor or lessor accept any responsibility in respect of these particulars, which are not intended to be statements or representations of fact and any intending purchaser or lessee must satisfy himself by inspection or otherwise as to the correctness of each of the statements contained in these particulars. Any floorplans on this brochure are for illustrative purposes only and are not necessarily to scale.

Offices at: Chorlton, Didsbury, Disley, Hale, Glossop, Macclesfield, Manchester Deansgate, Manchester Whitworth Street, New Mills, Sale, Wilmslow and Withington

245 Deansgate, Manchester, M3 4EN

0161 833 9499 opt 3

manchester@jordanfishwick.co.uk

www.jordanfishwick.co.uk

